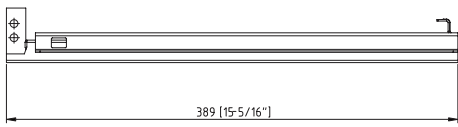
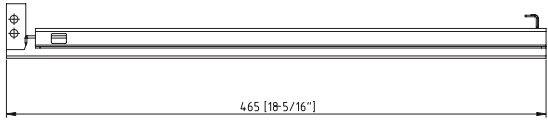
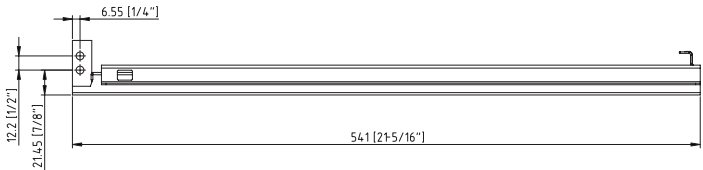

# 3/4 Extension Undermount Slide for Face Frame Construction

## Construction & Assembly Specifications

	Slide Length	Total Cabinet Depth	Overall Drawer Length	FACE FRAME	
				Min Inside Cabinet Depth	Max Inside Cabinet Depth
	15-5/16" 389mm	18" 457mm	15" 381mm	15-7/8" 403mm	17-9/16" 446mm
	18-5/16" 465mm	21" 533mm	18" 457mm	18-7/8" 479mm	20-9/16" 522mm
	21-5/16" 541mm	24" 610mm	21" 533mm	21-7/8" 555mm	23-9/16" 598mm

functional

Assume 4mm (5/32") setback from drawer opening

Rear brackets for face frame applications will yield a 5mm-48mm (3/16" - 1-7/8") depth adjustment

For inset drawer front applications:

Setback: 5mm (3/16") + Drawer Front Thickness

For face frame cabinets, Inside Cabinet Depth Minimum = Slide Length + Setback + 5mm (3/16")

Inside Cabinet Depth Maximum = Slide Length + Setback + 48mm (1-5/16")

### FRONT VIEW OF THE DRAWER INSIDE THE CABINET

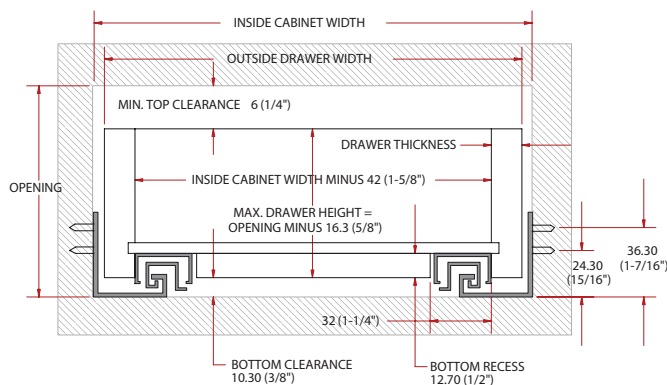

Maximum Drawer Height = Opening - 20mm (13/16")

### OUTSIDE DRAWER WIDTH CALCULATIONS

Drawer Side Thickness	5/8"	19/32"	9/16"	1/2"	15/32"
Thickness	16mm	15mm	14mm	13mm	12mm
Inside Cabinet Width Deduction	3/8"	15/32"	9/16"	5/8"	23/32"
	10mm	12mm	14mm	16mm	18mm